

DISASSEMBLY

1. REMOVE HEADREST
2. REMOVE POWER SEAT SWITCH KNOBS
3. REMOVE FRONT SEAT INNER BELT
4. REMOVE NO. 1 FRONT SEAT CUSHION SHIELD
5. REMOVE FRONT SEAT CUSHION SHIELD
6. REMOVE FRONT SEAT INNER CUSHION COVER
7. REMOVE SEAT CUSHION ASSEMBLY
 - (a) Remove the wire harness from the seat cushion assembly.
 - (b) Remove the 4 bolts and seat cushion assembly from the seat adjuster.
8. REMOVE SEAT CUSHION COVER
 - (a) Remove the 2 bolts and hog rings.
 - (b) Remove the seat cushion cover with pad from the seat cushion frame.
 - (c) Remove the seat cushion cover from the seat cushion pad.
9. REMOVE SEATBACK ASSEMBLY
 - (a) Remove the 2 screws and pull the seatback board downward to remove it.
 - (b) Remove the hog rings.
 - (c) Disconnect the connectors.
 - (d) Remove the 4 bolts.

NOTICE:

Be careful not to damage the wire harness.

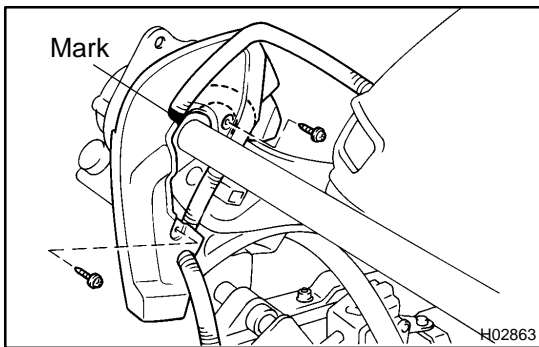

- (e) Remove the 4 screws and seat cushion inside covers, then disconnect the wire harness from the cover.
- (f) Remove the covers from the outer and inner seat tracks.

10. REMOVE SEATBACK COVER

- (a) Remove the hog rings.
- (b) Release the clamp.
- (c) Remove the 2 bolts and release the seat cover hook and retainer from the seatback frame.
- (d) Remove the headrest supports.
- (e) Remove the seatback cover with pad from the seatback frame.
- (f) Remove the 2 bolts and lumbar support assembly from the seatback frame.
- (g) Remove the hog rings and seatback cover from the seatback pad.

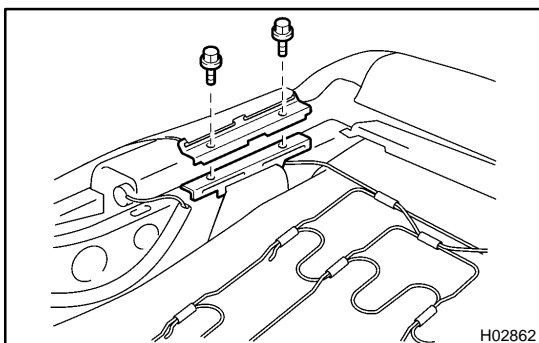

11. REMOVE POWER SEAT SWITCH

Remove the 2 screws and power seat switch.

12. REMOVE WIRE HARNESS

Disconnect the connectors, then remove the wire harness.

13. w/ Power seat control:**REMOVE SEAT POSITION CONTROL RELAY**

Remove the 2 nuts and seat position control relay.

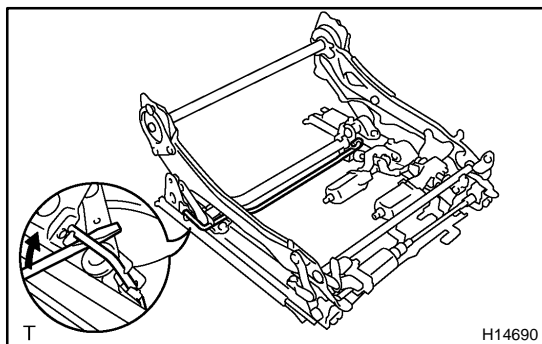
**14. REMOVE TORSION BAR**

Using a screwdriver, remove the torsion bar.

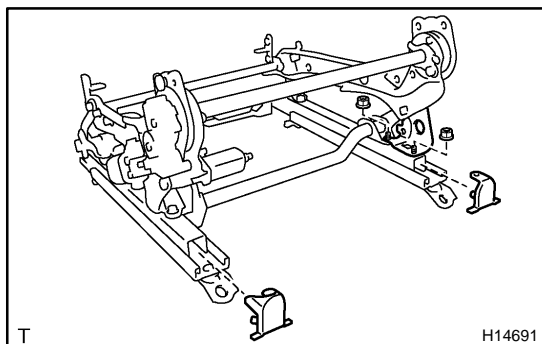
**15. REMOVE SEAT TRACK COVERS AND BELT ANCHOR BRACKET**

- (a) Using a screwdriver, remove the 2 seat track covers.
- (b) Remove the 2 nuts and belt anchor bracket.

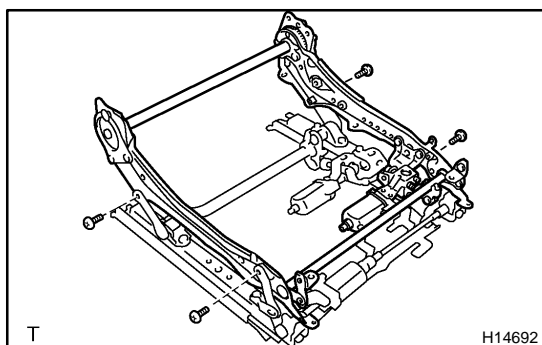
**16. REMOVE RECLINING SEAT ADJUSTER ASSEMBLY WITH NO. 2 VERTICAL SEAT LINK SUB-ASSEMBLY**

- (a) Using a torx socket wrench, remove the 4 bolts and reclining seat adjuster assembly with No. 2 vertical seat link sub-assembly.

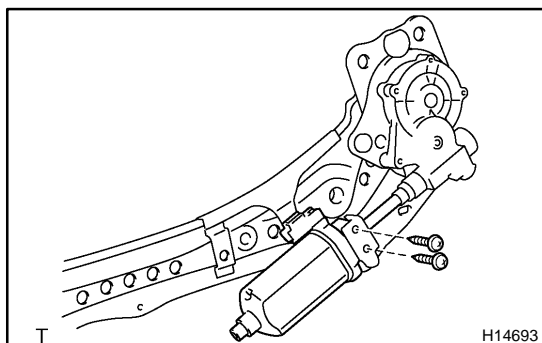

- (b) Remove the 2 screws.
- (c) Disconnect the shaft, then remove the reclining motor.

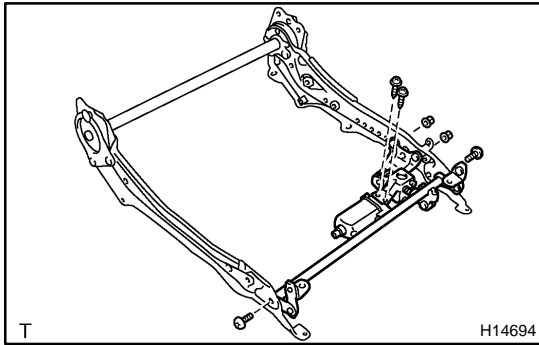

17. REMOVE NO. 2 VERTICAL SEAT LINK SUB-ASSEMBLY AND FRONT VERTICAL MOTOR

- Using a torx socket wrench, remove the 2 bolts.
- Remove the 2 nuts and No. 2 vertical seat link sub-assembly.
- Remove the 2 screws and front vertical motor.

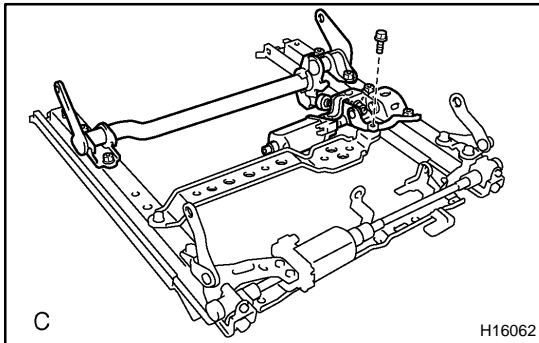

18. REMOVE VERTICAL SEAT LINK SUB-ASSEMBLY AND REAR VERTICAL MOTOR

- w/ Power seat control:
Remove the bolt.

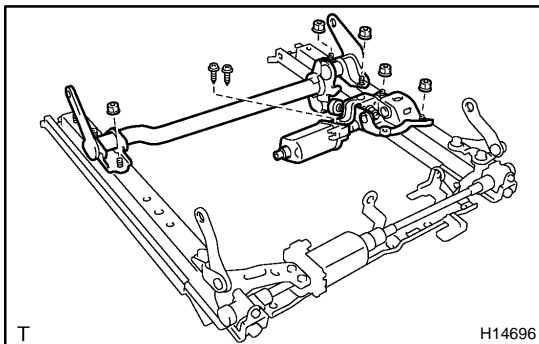

- Remove the 5 nuts, plate and vertical seat link sub-assembly.
- Remove the 2 screws and rear vertical motor.

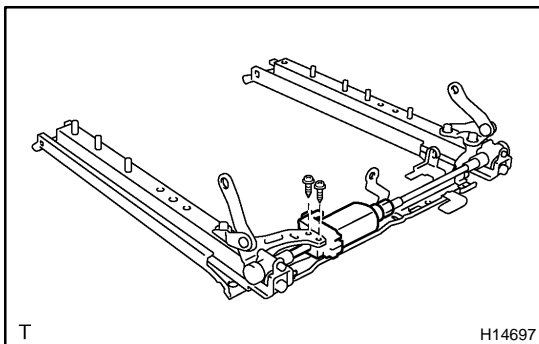

19. REMOVE SLIDE MOTOR

- Remove the 2 screws.
- Disconnect the seat adjuster drive cable, then remove the slide motor.